

【 Cross-reference table 】

Series name λ-13(1113)

	λ-13 (1113) series	RJ-13
Resistive element	Wirewound	Cermet
Mechanical Turn	1 turns	←
Mechanical angle	310°	270°
Operating torque	19.61mN·m maximum	3~35mN·m maximum
Stop strength	98.07mN·m maximum	100mN·m maximum
Rotational life	200 cycles	←
Electrical continuity	Continuous for full mechanical range	230°
Power rating	0.75W(70°C)	←
Resistance tolerance	±10%	←
End resistance	2 % or 1 Ω, whichever is greater	1 % or 2 Ω, whichever is greater
Temp. coefficient	±50 10 ⁻⁶ /°C maximum	10,20,5MΩ:±250 10 ⁻⁶ /°C maximum 50~2MΩ :±100 10 ⁻⁶ /°C maximum
Insulation resistance	1000MΩminimum (DC500)	←
Dielectric strength	AC900V,60s	←
Operating temp. range	-55°C~+120°C	←
Outline	Dimension	φ13.5×6.8mm
	Color	Gray
	Remarks	Please refer to "OUTLINE DIMENSIONS" for more details.

COPAL ELECTRONICS

OUTLINE DIMENSIONS

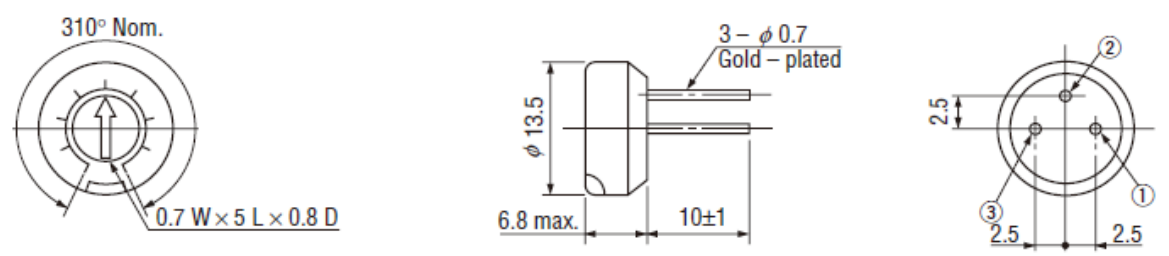
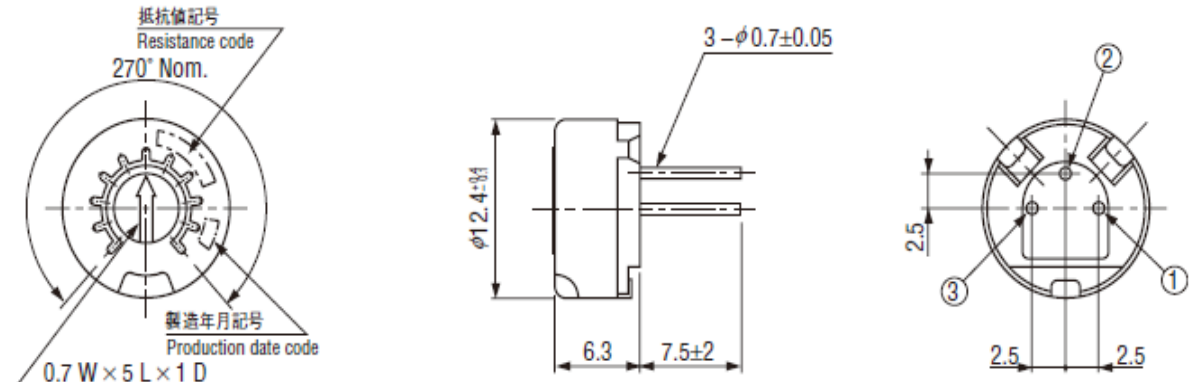
<p>λ-13T (1113T)</p>	 <p>310° Nom. 0.7 W × 5 L × 0.8 D</p> <p>φ 13.5 6.8 max. 10 ± 1</p> <p>3 - φ 0.7 Gold-plated</p> <p>2.5 2.5 2.5</p>
<p>RJ-13P</p>	 <p>抵抗値記号 Resistance code 270° Nom. 製造年月記号 Production date code 0.7 W × 5 L × 1 D</p> <p>φ 12.4 ± 0.04 6.3 7.5 ± 2</p> <p>3 - φ 0.7 ± 0.05</p> <p>2.5 2.5 2.5</p>

COPAL ELECTRONICS

OUTLINE DIMENSIONS

<p>λ-13TR (1113TR)</p>	
<p>RJ-13PR</p>	

COPAL ELECTRONICS

OUTLINE DIMENSIONS

<p>λ-13S (1113S)</p>	<p>310° Nom. 0.7 W × 5 L × 0.8 D</p> <p>10±1</p> <p>9.6 max.</p> <p>14.5 max.</p> <p>3 - φ 0.7 Gold - plated</p> <p>2.5, 1.4, 2.5, 2.5, 13.5</p>
<p>RJ-13S</p>	<p>0.7 W × 5 L × 1 D</p> <p>270° Nom.</p> <p>Resistance code 抵抗値記号</p> <p>Production date code 製造年月記号</p> <p>7.3, 13.6^{+0.1}</p> <p>7.5±2</p> <p>調整面 Adjustment</p> <p>1, 2, 3</p> <p>2.5, 2.5, 12.5^{+0.1}</p> <p>1.2, 2.5, 8.8^{+0.1}</p> <p>3 - φ 0.7±0.05</p>

COPAL ELECTRONICS

OUTLINE DIMENSIONS

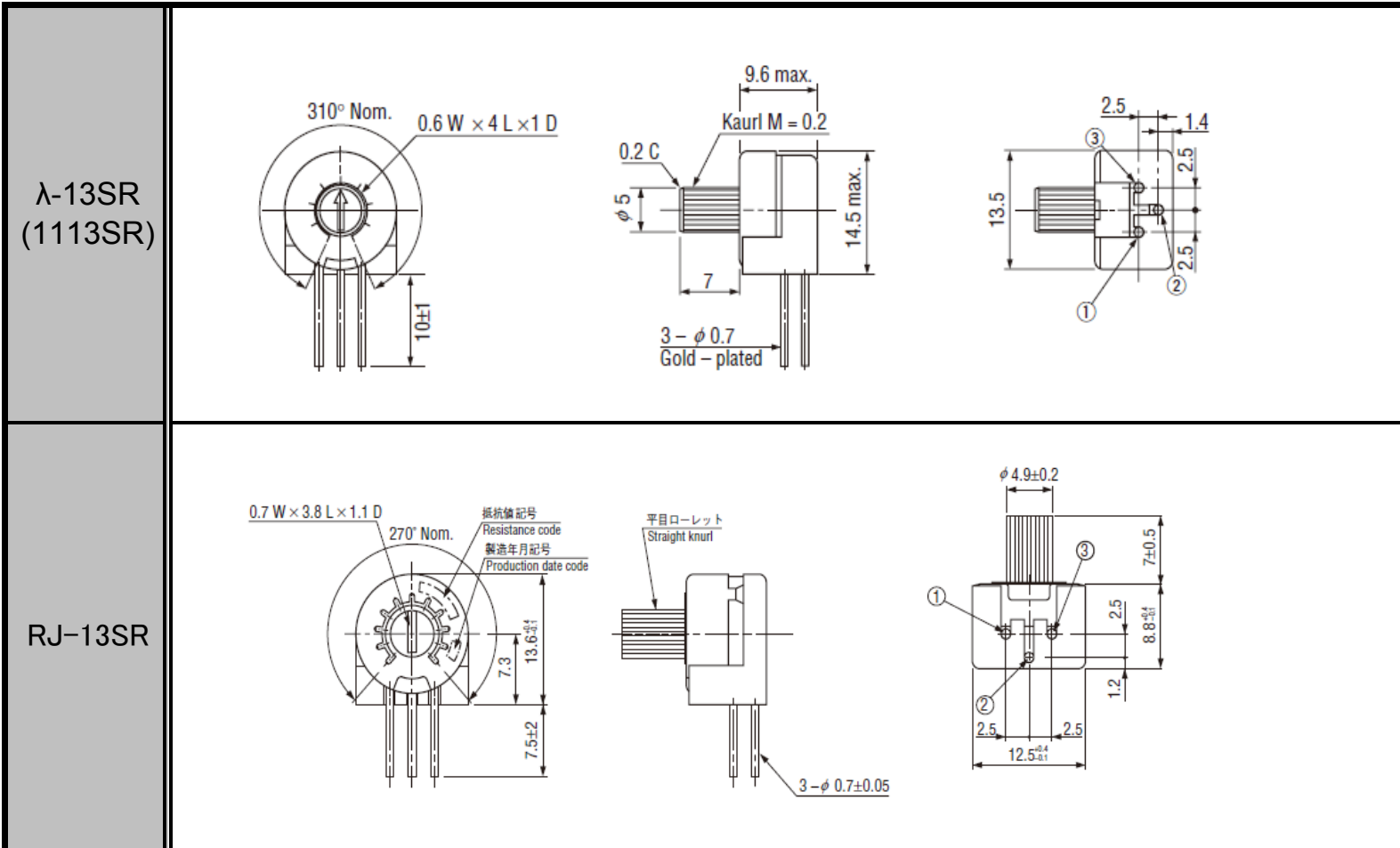

COPAL ELECTRONICS

OUTLINE DIMENSIONS

<p>λ-13B (1113B)</p>	<p>310° Nom.</p> <p>φ 15 max. Stopper range</p> <p>M 5 (P = 0.8) (ISO)</p> <p>3 - φ 0.7 Gold-plated</p> <p>R 1</p> <p>φ 9</p> <p>0.6</p> <p>1</p> <p>7</p> <p>8 max.</p> <p>8±0.4</p> <p>14±1</p> <p>2.5</p> <p>2.5</p>
<p>RJ-13B</p>	<p>φ 14 max.</p> <p>ストップ位置 90° Mechanical stops</p> <p>M5 (P = 0.8 L = 6 min.) Nut M5, t = 3.2 Washer t = 1</p> <p>抵抗値記号及び製造年月記号 Resistance code & Production date code</p> <p>3 - φ 0.7±0.05</p> <p>φ 9</p> <p>0.6</p> <p>1</p> <p>7</p> <p>7.5±0.5</p> <p>7±2</p> <p>2.5</p> <p>2.5</p> <p>2.5</p> <p>0.6</p> <p>赤ペイント Red paint</p> <p>シャフト部詳細図 Shaft details</p>

COPAL ELECTRONICS

OUTLINE DIMENSIONS

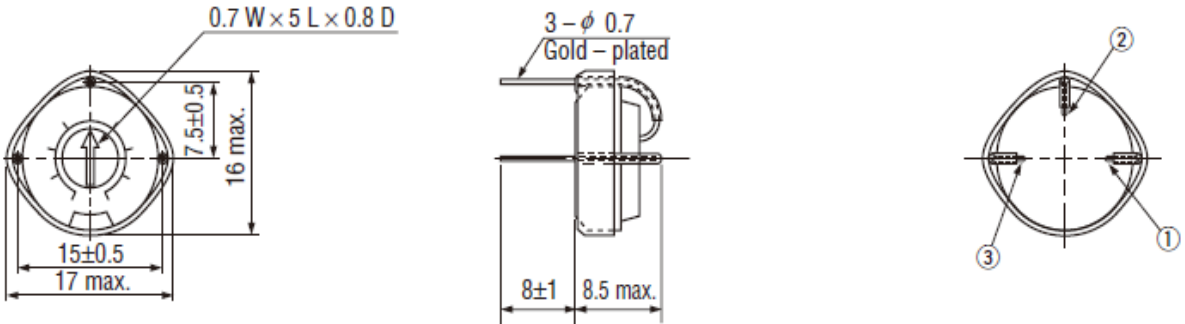
<p>λ-13F (1113F)</p>	 <p>Technical drawing of the λ-13F (1113F) connector. It includes three views: a front view, a side view, and a top view. The front view shows a circular component with a diameter of 15 ± 0.5 and a maximum diameter of 17. The height is 16 with a maximum of 7.5 ± 0.5. A label $0.7 W \times 5 L \times 0.8 D$ points to the top surface. The side view shows a height of 8 ± 1 and a maximum height of 8.5. The top view shows three gold-plated contacts, each with a diameter of 0.7. The top view is numbered 1, 2, and 3.</p>
<p>RJ-13</p>	<p>N/A</p>

COPAL ELECTRONICS

OUTLINE DIMENSIONS

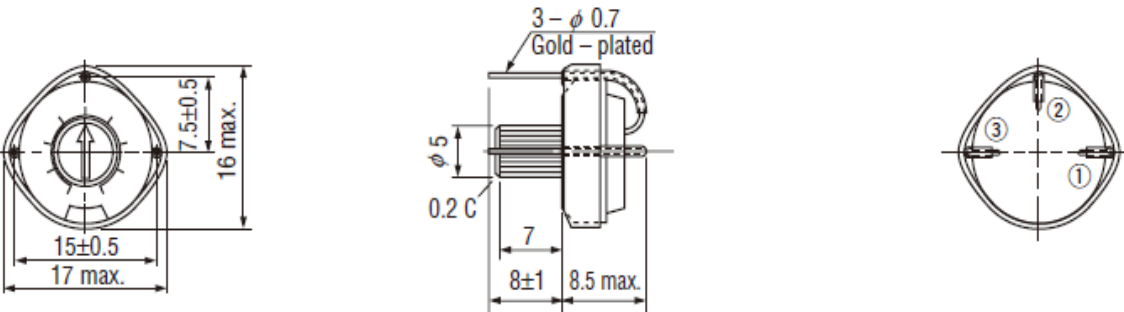
λ-13FR (1113FR)	
RJ-13	N/A

COPAL ELECTRONICS